

# #1 - 1891 Marine Drive, West Vancouver, B.C.

**Totals\*\***

Main Level:	1,374 sq. ft.
Deck 1:	47 sq. ft.
Deck 2:	71 sq. ft.
<b>Total:</b>	<b>118 sq. ft.</b>

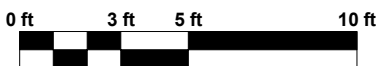
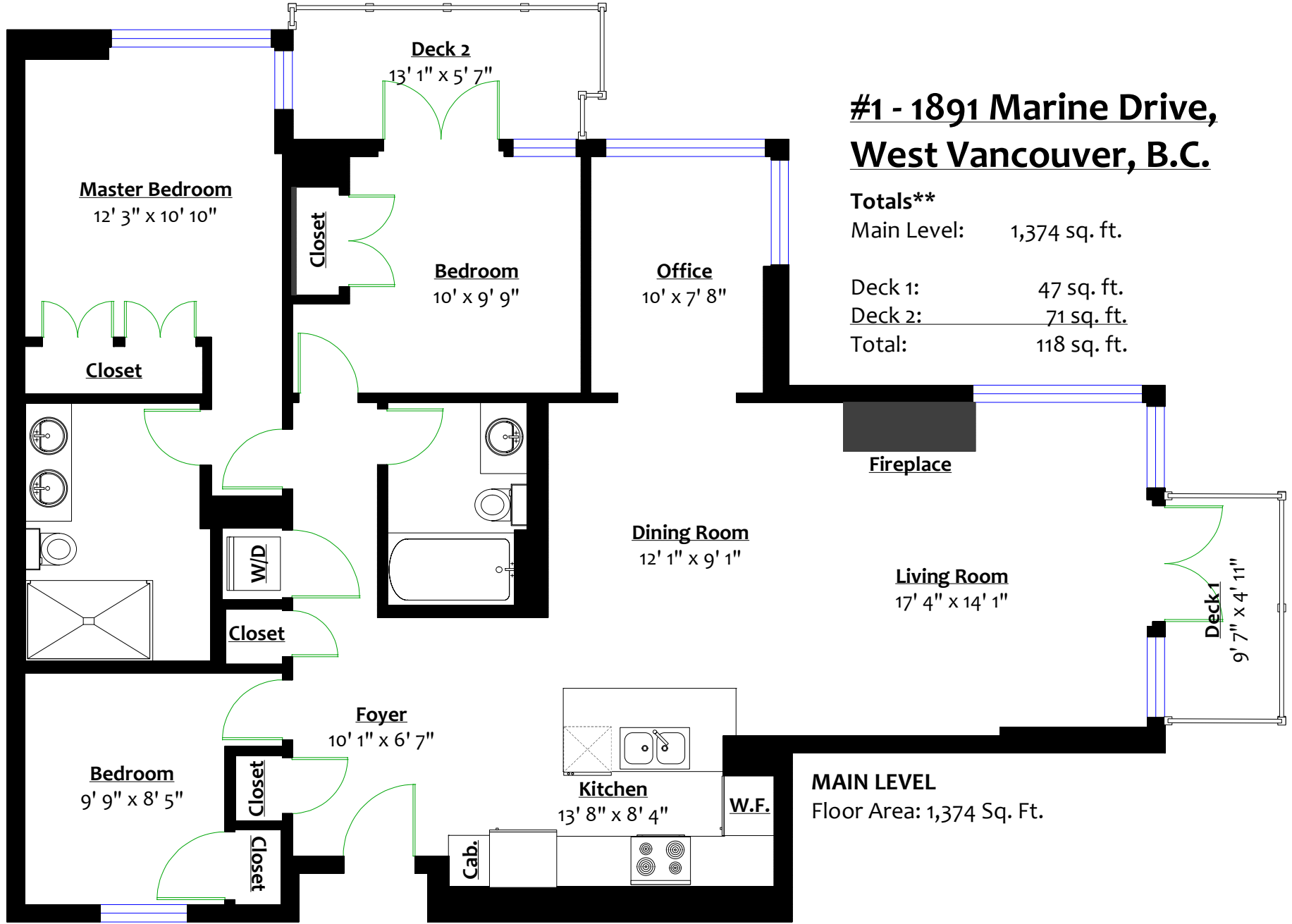

\*\* Approx. based on interior measurements to exterior walls  
\*\* Total square footage not taken from original blueprints